

NASCAR/MSA Super Weekend							
INDYCAR/MSA CIRCUIT GEOMETRICS							
Prepared by Kevin H. Forbes, P.E., Director of Engineering 6/23/2014							
Section	Length (CL)		Radius (CL)		Direction		Width
	(ft)	(m)	(ft)	(m)	Left	Right	
Straight 1A	2,148.45	654.85					50.00 15.24
Turn 1			43.68	13.31	27.00	8.23	Right Note 1 Note 1
Straight 2	187.50	57.15					46.00 14.02
Turn 2			246.64	75.18	148.40	45.23	Left
Straight 3	115.42	35.18					46.00 14.02
Turn 3			488.01	148.75	309.50	121.77	Right
Straight 4	184.00	56.08					46.00 14.02
Turn 4A			101.36	30.89	115.52	35.21	Right
Turn 4B			254.10	77.45	228.50	69.85	Right
Straight 5	340.75	103.86					46.00 14.02
Turn 5			142.59	43.49	118.81	36.15	Left
Turn 6			87.18	26.57	72.94	22.21	Right
Straight 6	2,509.16	764.79					46.00 14.02
Turn 7			65.15	19.86	40.51	12.35	Left
Straight 7	330.25	100.68					46.00 14.02
Turn 8			255.72	77.94	180.37	54.98	Right
Turn 9			228.53	69.65	190.29	48.85	Left
Straight 8	242.92	74.04					46.00 14.02
Turn 10A			99.19	30.23	85.50	26.06	Right
Turn 10B			301.23	91.81	474.50	144.63	Right
Straight 9	393.00	119.79					46.00 14.02
Turn 11A			521.15	158.85	348.89	107.81	Right
Turn 11B			146.34	44.60	506.74	154.85	Right
Turn 11C			696.56	203.17	8,999.44	1,523.83	Right
Straight 10	27.66	8.43					46.00 14.02
Turn 12			68.73	20.95	43.78	13.34	Right
Straight 11	358.16	109.47					46.00 14.02
Turn 13A			135.57	41.32	156.49	47.39	Left
Turn 13B			68.95	21.33	62.98	19.20	Left
Straight 12	283.08	86.28					46.00 14.02
Turn 14A			517.30	157.87	382.00	116.43	Right
Turn 14B			530.33	161.64	320.79	98.00	Right
Straight 1B	788.14	240.13					50.00 15.24
Totals:	7,889.49 ft	4,967.31 m					
Totals:	2,434.72 mi	1,568.72 mi					
	Total Circuit Length: (ft)	12,856.80 ft					
	Total Circuit Length: (mi)	2,435.00 mi					
	Total Circuit Length: (km)	3,918.90 km					

Note 1: Transitions from 50.00 feet to 46 feet (15.24 m to 14.02 m)
 Note 2: Transitions from 46 feet to 50.00 feet (14.02 m to 15.24 m)

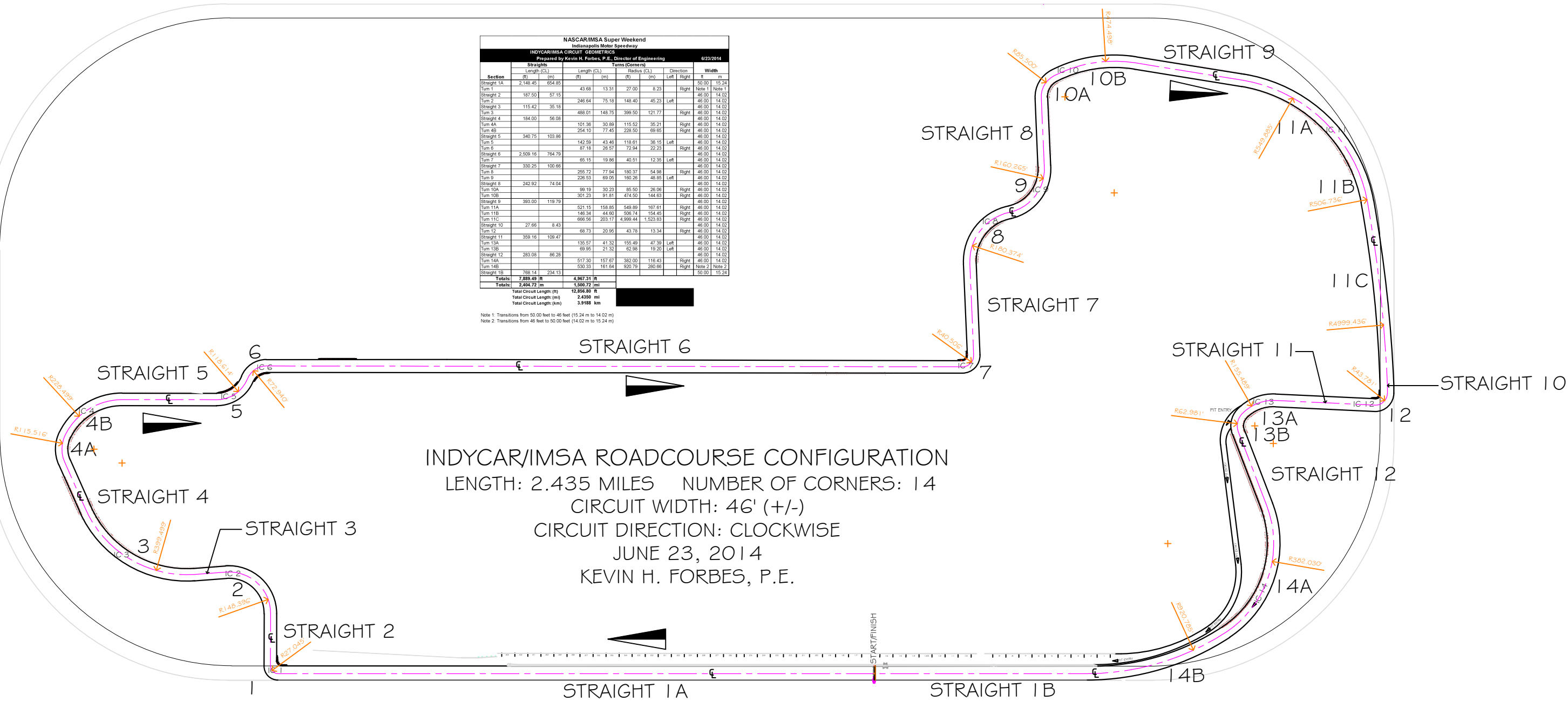

INDYCAR/MSA ROADCOURSE CONFIGURATION
 LENGTH: 2.435 MILES NUMBER OF CORNERS: 14
 CIRCUIT WIDTH: 46' (+/-)
 CIRCUIT DIRECTION: CLOCKWISE
 JUNE 23, 2014
 KEVIN H. FORBES, P.E.

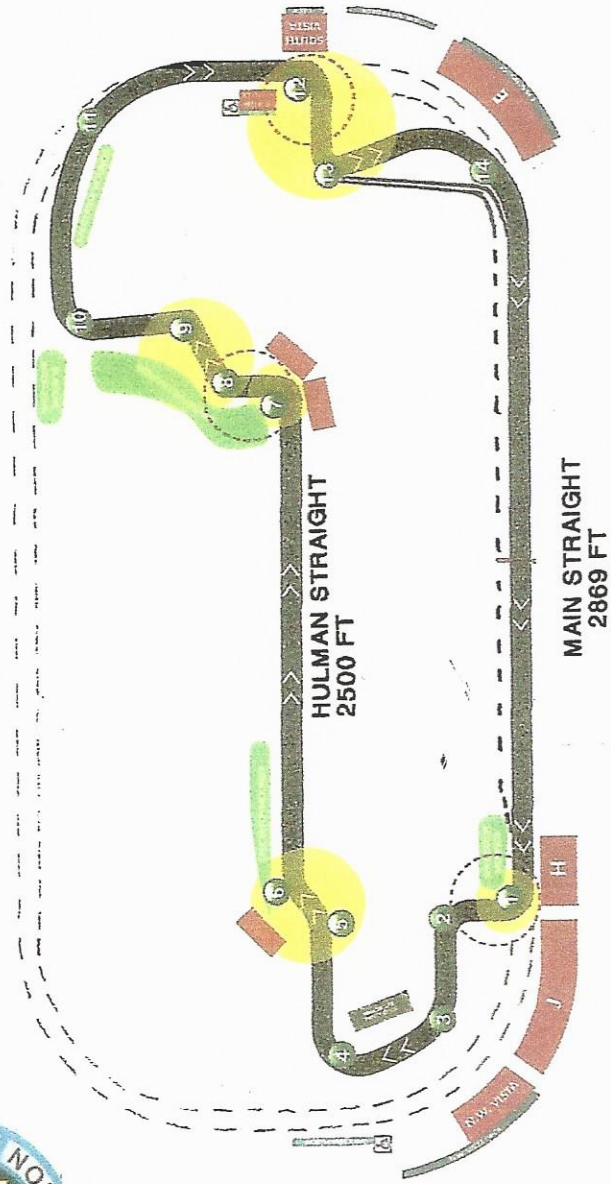

ROAD CIRCUIT--REVISED 2014
2.43 MILES--CLOCKWISE

NEW CORNERS



INDIANAPOLIS MOTOR SPEEDWAY

2015 ROAD CIRCUIT